

SET MOLE STANDARD PER SAGOME "PE"

STANDARD SET WHEELS FOR "PE" SHAPE

Ø 150 Foro 50 / Hole 50 (mm)

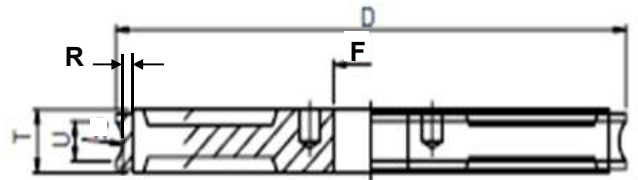

Pos	Vetro Glass	Duezeta Code	Descrizione / Description	Specif. 2Z	Note
U*	2	140007000268	1FF6Y F.50 Ø150 G.03 R.3 GR.MEDIA-K C.ST LEG.SLV1	230 SLV1	Unica standard
U*	3	140007000269	1FF6Y F.50 Ø150 G.04 R.3 GR.MEDIA-K C.ST LEG.SLV1	230 SLV1	Unica standard
U*	3	140007000270	1FF6Y F.50 Ø150 G.04 R.3 GR.FINE-J C.ST LEG.SLV1	270 SLV1	
1	4	140007000271	1FF6Y F.50 Ø150 G.05 R.3 GR.GROSSA-P C.ST LEG.SLV1	100 SLV1	
2	4	140007000272	1FF6Y F.50 Ø150 G.05 R.3 GR.FINE-K C.ST LEG.SLV1	230 SLV1	
2Alt	4	140007000273	1FF6Y F.50 Ø150 G.05 R.3 GR.FINE-J C.ST LEG.SLV1	270 SLV1	Opt. Pos.2
1	5	140007000274	1FF6Y F.50 Ø150 G.06 R.3 GR.GROSSA-P C.ST LEG.SLV1	100 SLV1	
2	5	140007000275	1FF6Y F.50 Ø150 G.06 R.3 GR.FINE-K C.ST LEG.SLV1	230 SLV1	
U*	5	140007000276	1FF6Y F.50 Ø150 G.06 R.3 GR.MEDIA-L C.ST LEG.SLV1	200 SLV1	Unica standard
U*	5	140007000277	1FF6Y F.50 Ø150 G.06 R.3 GR.FINE-J C.ST LEG.SLV1	270 SLV1	Opt. Pos.2
1	6	140007000278	1FF6Y F.50 Ø150 G.07 R.3 GR.GROSSA-P C.ST LEG.SLV1	100 SLV1	
U*	6	140007000279	1FF6Y F.50 Ø150 G.07 R.3 GR.MEDIA-L C.ST LEG.SLV1	200 SLV1	Unica standard
2	6	140007000280	1FF6Y F.50 Ø150 G.07 R.3 GR.FINE-K C.ST LEG.SLV1	230 SLV1	
2Alt	6	140007000281	1FF6Y F.50 Ø150 G.07 R.3 GR.FINE-J C.ST LEG.SLV1	270 SLV1	Opt. Pos.2
1	8	140007000282	1FF6Y F.50 Ø150 G.09 R.3 GR.GROSSA-P C.ST LEG.SLV1	100 SLV1	
U*	8	140007000283	1FF6Y F.50 Ø150 G.09 R.3 GR.MEDIA-M C.ST LEG.SLV1	170 SLV1	Unica standard
2	8	140007000284	1FF6Y F.50 Ø150 G.09 R.3 GR.FINE-K C.ST LEG.SLV1	230 SLV1	
1	10	140007000285	1FF6Y F.50 Ø150 G.11 R.3 GR.GROSSA-P C.ST LEG.SLV1	100 SLV1	
U*	10	140007000286	1FF6Y F.50 Ø150 G.11 R.3 GR.MEDIA-M C.ST LEG.SLV1	170 SLV1	Unica standard
2	10	140007000287	1FF6Y F.50 Ø150 G.11 R.3 GR.FINE-K C.ST LEG.SLV1	230 SLV1	
1	12	140007000288	1FF6Y F.50 Ø150 G.13 R.3 GR.GROSSA-P C.ST LEG.SLV1	100 SLV1	
2	12	140007000289	1FF6Y F.50 Ø150 G.13 R.3 GR.FINE-K C.ST LEG.SLV1	230 SLV1	

PARAMETRI DI LAVORO / WORKING PARAMETERS



Pos.1
(Met.bond)

Pos.2
(Met.bond)

Pos.3
(Polishing)

Grana / Grit	RPM (giri/')	Asportazione Removal	Avanzamento / Feed	
			Glass 2÷4mm	Glass 5÷12mm
100 to 120	5000 ÷ 6.500	1÷2 mm	8 ÷ 12 m/min	6 ÷ 12 m/min
230 to 270	5000 ÷ 6.500	0,5÷0,8 mm	6 ÷ 10 m/min	6 ÷ 10 m/min
600	5000 ÷ 6.500	0,1÷0,2 mm	6 ÷ 10 m/min	4 ÷ 6 m/min